

Informative Guide

WELCOME

MUSEO NACIONAL
CENTRO DE ARTE
REINA SOFÍA



GOBIERNO DE ESPAÑA

MINISTERIO DE CULTURA Y DEPORTE

MAIN VENUE

Access:

Sabatini Building, Santa Isabel, 52. Madrid
Nouvel Building, Ronda de Atocha, s/n. Madrid

Opening hours

Monday from 10:00 am to 9:00 pm

Tuesday CLOSED

Wednesday to Saturday from 10:00 am to 9:00 pm

Sunday from 10:00 am to 2:30 pm

Free admission (except groups)

Monday from 7:00 pm to 9:00 pm

Wednesday to Saturday from 7:00 pm to 9:00 pm

Sunday from 1:30 pm to 2:30 pm

18 April, 18 May, 12 October and 6 December

MAIN VENUE

NOUVEL BUILDING

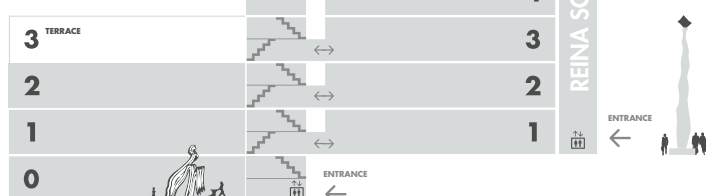

PARQUE DEL RETIRO VENUES

Palacio de Cristal* and **Palacio de Velázquez**

Free admission - Open every day

April to September from 10:00 am to 10:00 pm

March and October from 10:00 am to 7:00 pm

November to February from 10:00 am to 6:00 pm

* Palacio de Cristal will be closed on rainy days

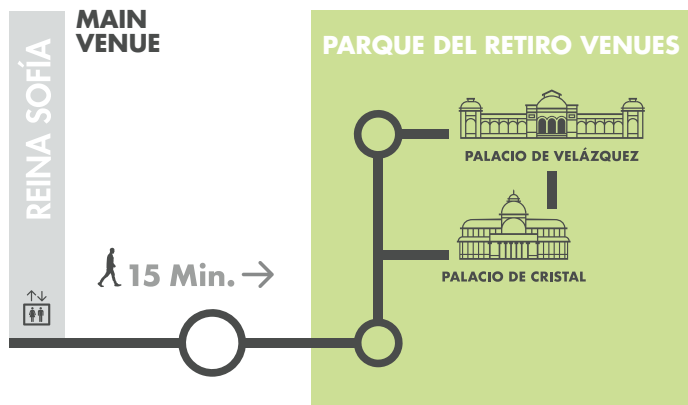

INDIVIDUAL FEES

General admission online  **4€**

General admission **5€**

Reduced admission with valid accreditation **2,5€**

Large families | Cultural volunteers | Personnel of other museums

General admission with audioguide

Pass for two visits in one

Activated after the first visit | Personal and non-transferable

CARDS AND MEMBERSHIPS*

Paseo del Arte Card

Annual Membership Card for National Museums

GROUP VISITS

Groups are admitted subject to prior online booking and payment of fees. Between 8 and 25 pax

GUIDED TOURS

 Duration: between 20 minutes and 2 hours approx.

 Capacity: 11 people

 Meeting Point:
Sabatini Garden Gate

 Free Activity

* Due to the preventive measures set against Covid-19 some services are temporarily unavailable.

COLLECTION

The Irruption of the 20th Century: Utopias and Conflicts (1900-1945)

Collection 1

Pablo Picasso, *Guernica*, 1937Joan Miró, *Portrait II (Retrato II)*, 1938Salvador Dalí, *Visage du Grand Masturbateur (Rostrum del Gran Masturbador)*, 1929Angeles Santos, *Tertulia*, 1929Maruja Mallo, *La verbena*, 1927Francis Picabia, *Totalisateur (Totalizador)*, 1922 (ca.)

Is the War Over? Art in a Divided World (1945-1968)

Collection 2

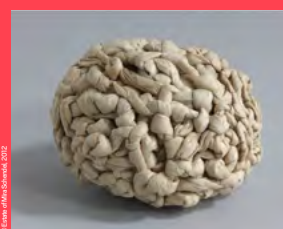
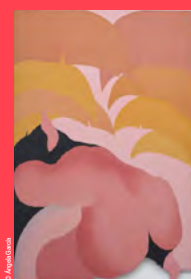
José Val del Omar, *Aguaspejo granadino*, 1953-1955Mira Schendel, *Sin título*, 1965Francis Bacon, *Lying Figure (Figura tumbada)*, 1966Ángela García Codoñer, *Divertimento*, 1973Constant, *Nébulose mécanique (Nebulosa mecánica)*, 1958Robert Motherwell, *Totemic Figure (Figura totemica)*, 1958Eduardo Arroyo, *España te miró*, 1967

From Revolt to Postmodernity (1962-1982)

Collection 3

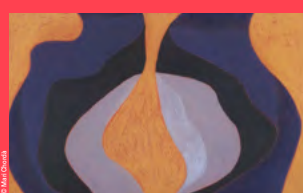
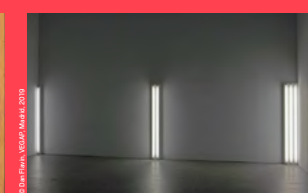
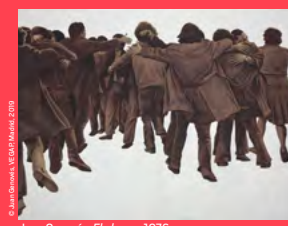
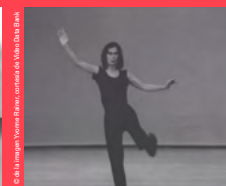
Mari Chordá, *La gran vagina*, 1966Dan Flavin, *The Nominal Three (To William of Ockham) (El tres nominal [para Guillermo de Ockham])*, 1963Antoni Tàpies, *Gran maró i fusta (Gran marón y madera)*, 1975Juan Genovés, *El abrazo*, 1976Luciano Fabro, *Vetro di Murano e seta indiana (Pie de vetro)* 1968-1972Colita, *S/T (portada del libro 'Antifemina')*, 1976Eduardo Chillida, *Espectador de espectadores*, 1972Ivonne Rainer, *Trío A*, 1978

4

Collection 2

[See more](#)

Is the War Over? Art in a Divided World (1945-1968)

José Val del Omar
Mira Schendel
Francis Bacon
Ángela García Codoñer

Constant
Robert Motherwell
Eduardo Arroyo

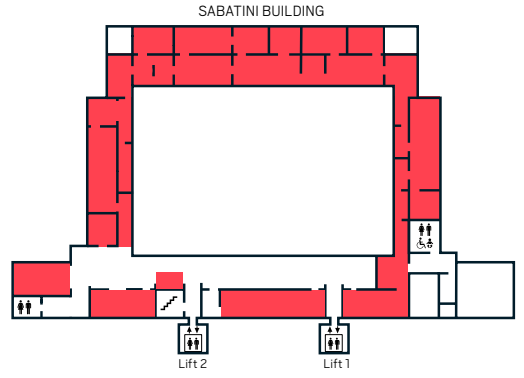

3

Temporary Exhibitions

[See more](#)

* check the open rooms on the Museum website

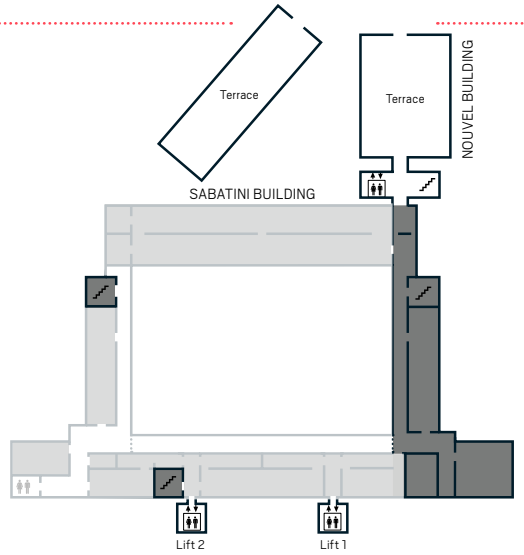

2

Collection 1

[See more](#)

The Irruption of the 20th Century: Utopias and Conflicts (1900-1945)

Pablo Picasso Ángeles Santos
Joan Miró Maruja Mallo
Salvador Dalí Francis Picabia

* check the open rooms on the Museum website

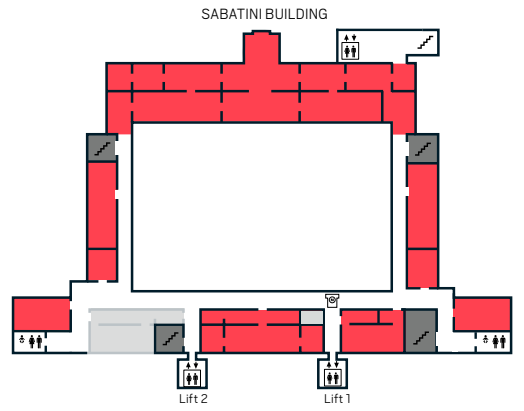

1

Collection 3

[See more](#)

From Revolt to Postmodernity (1962-1982)

Mari Chordà Juan Genovés
Dan Flavin Luciano Fabro
Antoni Tàpies Richard Serra

Temporary Exhibitions

[See more](#)

* check the open rooms on the Museum website

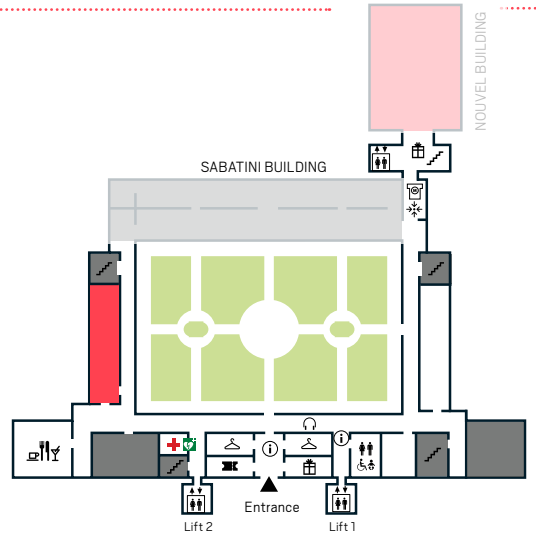

0

Collection

Temporarily
out of order

Temporary Exhibitions

[See more](#)

Library

* Limited capacity. Only for researchers by appointment

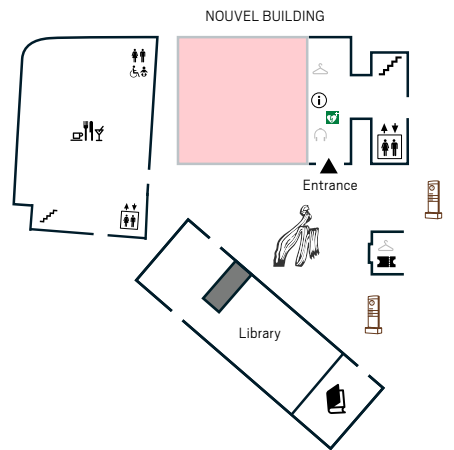

- Information Points
- Tickets
- ~~Cloakroom and lockers~~
- Baby carriers. Pushchair
- Wheelchair
- ~~Audio guide~~
- Lifts
- Staircases
- Adapted Restrooms
- Baby changing boards
- ~~Meeting Point~~
- Cultural Mediation
- Medical Assistance
- Defi brillator

La Central Bookshop

Monday to Friday from 12:00 pm to 8:45 pm
Saturday from 10:00 am to 8:45 pm
Tuesday and Sunday closed
Tel. (+34) 91 787 87 82

Museum Shop

Monday to Saturday 10:30 am to 8:30 pm
Sunday and holidays 10:30 am to 2:00 pm
(on Sundays Nouvel Building shop closes at 2:45 pm)
Tuesday closed
Tel. (+34) 91 539 21 51

Nubel Café/Restaurant

Wednesday and Thursday 12:00 pm to 12:00 am
Friday and Saturday 12:00 pm to 1:00 am
Sunday 11:00 am to 12:00 am
Monday and Tuesday closed
Tel. (+34) 91 530 17 61

Taberna Arzábal Café/Restaurant

Monday to Thursday 11:00 am to 1:00 am
Friday and Saturday 11:00 am to 1:00 am
Sunday 11:00 am to 8:00 pm
Tel. (+34) 91 528 68 28

Rest areas are located in the cloister and garden of the Sabatini Building and on the terraces of the Nouvel Building.

Access

Your ticket is valid for the whole day. Please hold on, it will be requested at the exit. Access with food and drinks is not permitted. Smoking is prohibited (including in open-air spaces). No sharp objects may be taken into the exhibition rooms. Access is allowed with small bags that carry personal belongings and small backpacks (40x40 cm)



No photography allowed in Rooms 206 | Guernica Gallery temperature with variations of +/- 1°C: 21°C | 22°C. Given the temperature inside the Museo, an item of warm clothing in summer is recommended. Guidance and assistance dogs access is guaranteed when holding the pertinent accreditation

Connect to our WiFi



More info: www.museoreinasofia.es



Consequence of the preventive protocol established against Covid-19, services and exhibition rooms will be opening gradually. Please, check the Museum website to see which ones are available at the time of your visit.

Please, respect the measures set for everybody's safety.

